

8 7 6 5 4 3 2 1

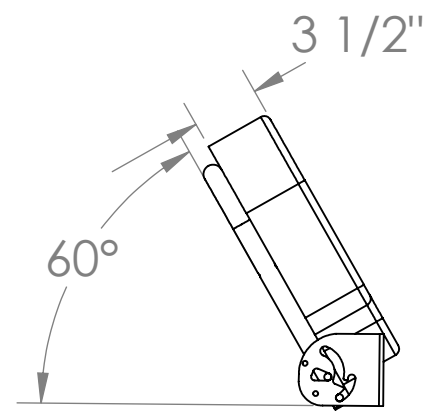

ELEVATED

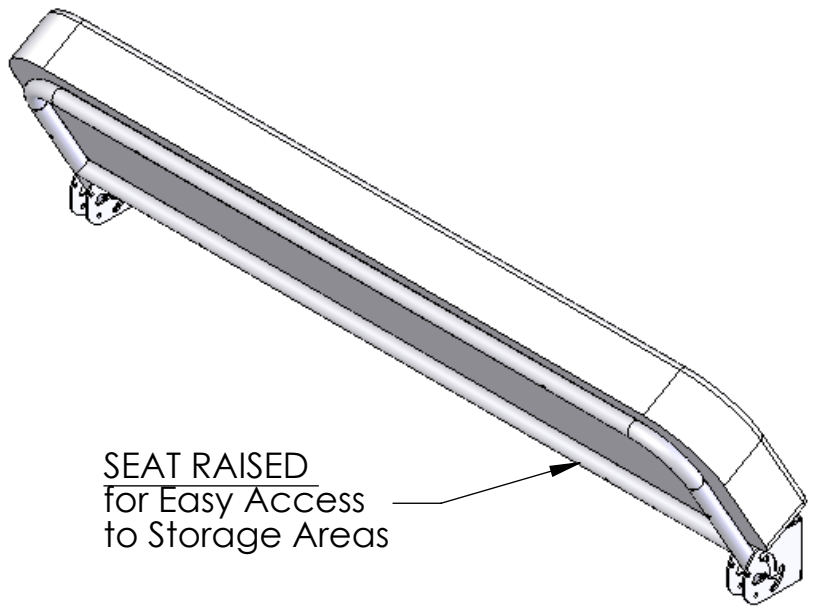

SEAT RAISED
for Easy Access
to Storage Areas

PART NO.	"F"	"W"
26534-19	19"	22"
26534-38	38"	41"
26534-52	52"	55"
26534-XX-CU	ADD "CU" FOR CUSHION	

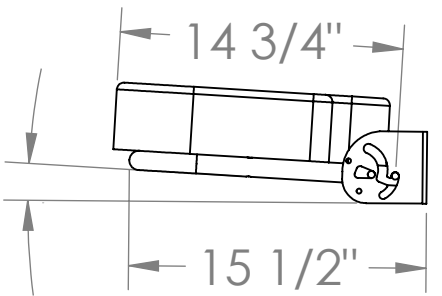
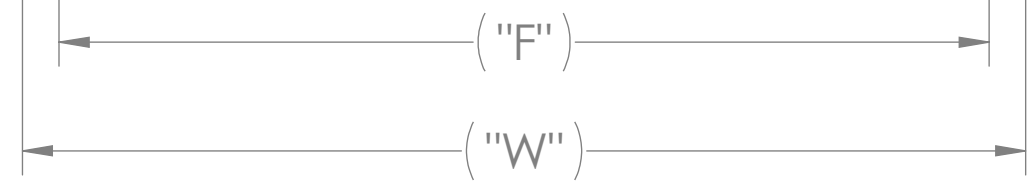
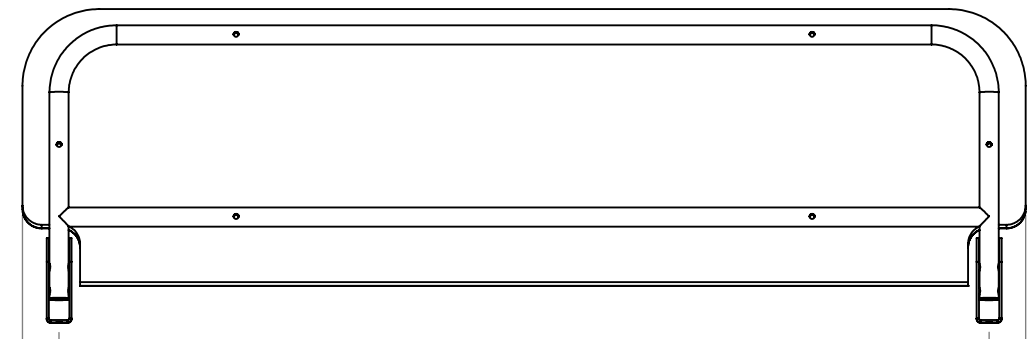
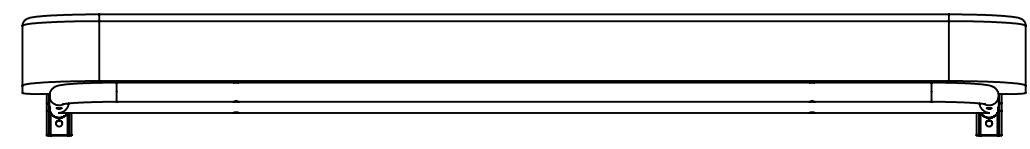
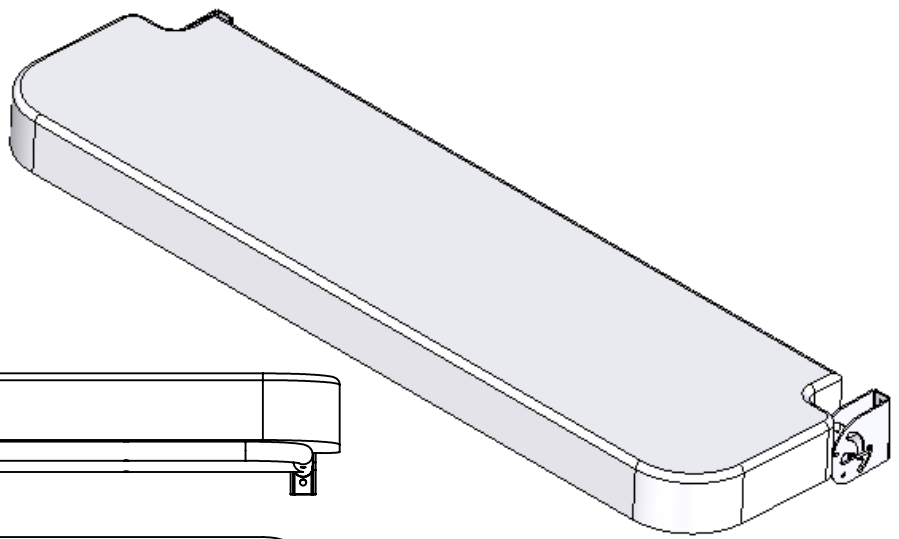

DEPLOYED

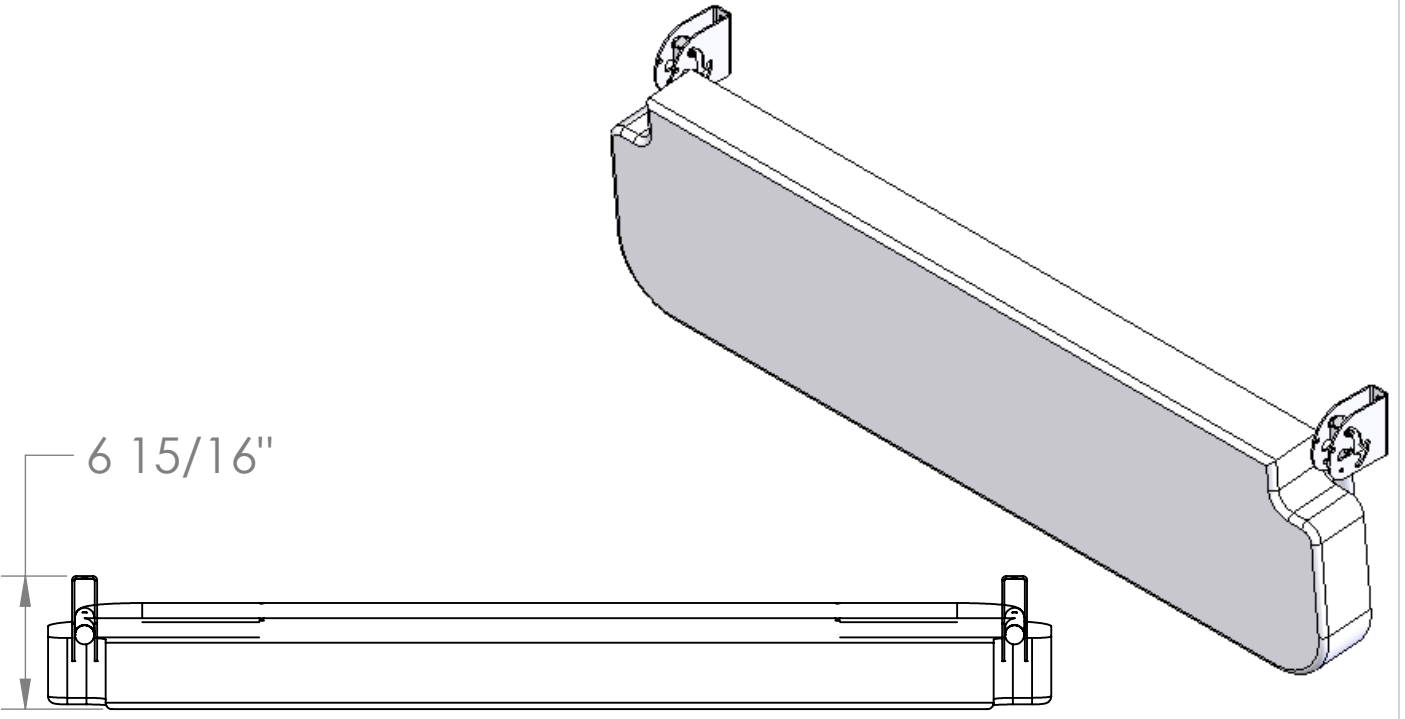

6 15/16"

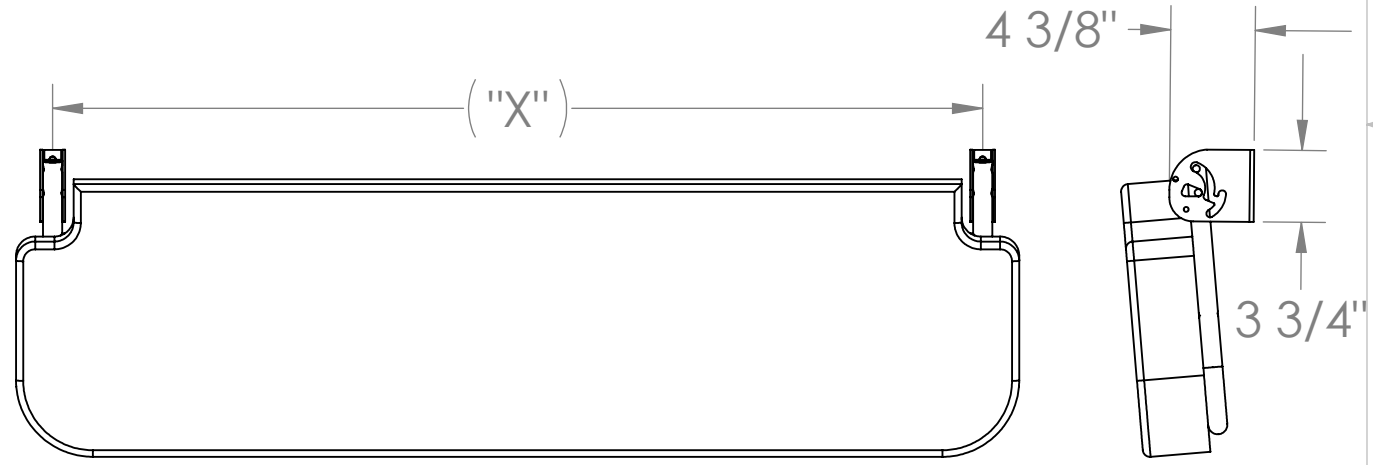
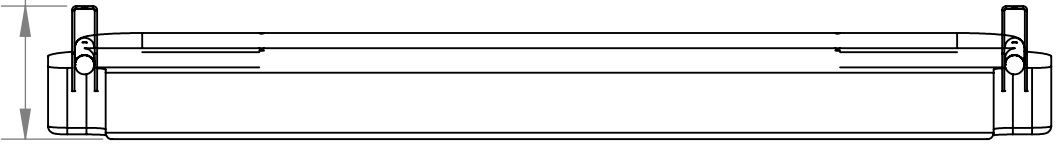

WIDTH RANGE
X = 19", 38", 52"

STOWED

NOTE:
ALL DIMENSIONS ARE FOR REFERENCE ONLY

UNLESS OTHERWISE SPECIFIED:
DIMENSIONS ARE IN INCHES
TOLERANCES:
FRACTIONAL ± 1/64"
ANGULAR: MACH ± 1 Deg.
BEND ± 1 Deg.
TWO PLACE DECIMAL ± .03"
THREE PLACE DECIMAL ± .015"

PROPRIETARY AND CONFIDENTIAL

THE INFORMATION CONTAINED IN THIS DRAWING IS THE SOLE PROPERTY OF G.G. SCHMITT & SONS. ANY REPRODUCTION IN PART OR AS A WHOLE WITHOUT THE WRITTEN PERMISSION OF G.G. SCHMITT & SONS IS PROHIBITED.

DO NOT SCALE DRAWING

2821 Old Tree Drive
Lancaster, PA 17403
717-394-3701

7230 15th Street East
Sarasota, FL 34243
941-360-1967

G.G. Schmitt & Sons

TITLE: **SEAT, BULKHEAD THREE POSITION**

SIZE	DWG. NO.	CUSTOMER NO.	DRAWN BY:	REV
B	26534	N/A	C.R.S.	0
SCALE: 1:10		DATE: 6/4/2010	SHEET 1 OF 1	

8 7 6 5 4 3 2 1